

NOTE: DO NOT DISCARD the Parts List from the Instruction Bulletin. Place the Parts List in the appropriate place in the machine manual for future reference. Retaining the Parts List will make it easier to reorder individual parts and will save the cost of ordering an entire kit.

NOTE: Numbers in parenthesis () are reference numbers for parts listed in Bill of Materials.

Installation instructions for **kit number 9002437**

SYNOPSIS:

This kit contains the parts needed to install a replacement panel label kit on T20 machines. Please follow step-by-step instructions.

SPECIAL TOOLS / CONSIDERATIONS: NONE

(Estimated time to complete: 1 hour)

PREPARATION:

1. Park the machine on a clean level surface, turn off the machine, remove the key, and set the parking brake.

FOR SAFETY: Before leaving or servicing machine, stop on level surface, set parking brake, turn off machine, and remove key.

2. First disconnect the negative terminal and then the positive terminal from the battery. Remove the battery from the machine.



WARNING: Always disconnect battery cables from machine before working on electrical components.

3. Disconnect the main wire harness from the circuit board.

*NOTE: **Do Not** discard the hex nuts removed in the following two steps if working on early production machines. The hex nuts are needed to install the new panel label (1) onto the dash panel.*

4. Remove the two hex nuts holding the battery flap and retaining bar to the back of the dash panel. Set the battery flap and retaining bar aside, and if working on an early production machine, set the hex nuts aside. Discard both hex nuts if working on a current production machine. Refer to Fig. 3.

5. Remove the two hex nuts holding the bottom of the control panel to the back of the dash panel. If working on an early production machine, set the hex nuts aside. Discard both hex nuts if working on a current production machine. Refer to Fig. 3.
6. Remove the control panel from the dash panel. Set the circuit board/control panel face down on a clean flat surface. Discard the four nylon bushings. Refer to Fig. 3.

INSTALLATION:

NOTE: Wear the ground strap (2) around wrist and connect other end to earth ground while assembling parts onto the new instrument panel label (1) in Steps 1 through 6.

1. Remove the back cover from the control panel. Set the back cover and hardware aside. Refer to Fig. 1.



FIG. 1

- Remove the six fasteners, six standoffs, and twelve nylon washers holding the circuit board to the panel assembly. Set the fasteners, standoffs, nylon washers, and circuit board aside. Refer to Fig. 2.

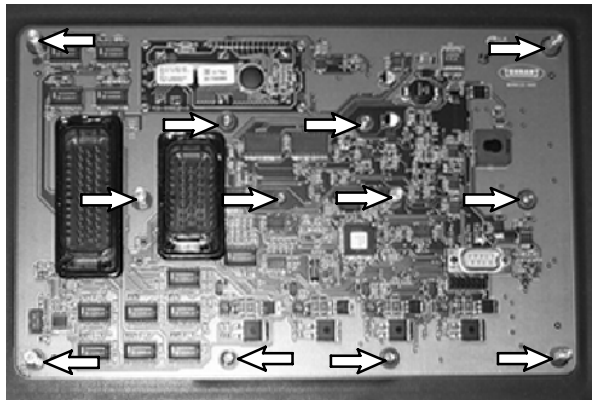

FIG. 2

- Remove the twelve aluminum spacers from the instrument panel label. Set the spacers aside. Discard the old instrument panel label. Refer to Fig. 2.
- Set the new instrument panel label (1) face down on a smooth clean surface and place the aluminum spacers onto the new instrument panel label. Refer to Fig. 2.

- Place the circuit board onto the aluminum spacers on the instrument panel label (1) and use the saved fasteners, standoffs, and nylon washers to secure the circuit board to the instrument panel label. Refer to Fig. 2.

NOTE: All twelve aluminum spacers must be installed onto instrument panel label (1). The circuit board could be damaged if any of the aluminum spacers are missing.

- Reinstall the back cover plate onto the control panel assembly. Refer to Fig. 1.
- Use the hex nuts (2), or saved hex nuts if working on an early production machine, and the four new nylon bushings (3) to install the control panel assembly, battery cover, and retaining bar onto the dash panel. Refer to Fig. 3.
- Reconnect the main wire harness to the circuit board.
- Set the battery into the battery compartment and reconnect the battery cables to the batteries (positive terminal first and then the negative terminal).
- Start and test the machine. Verify the machine operates properly.

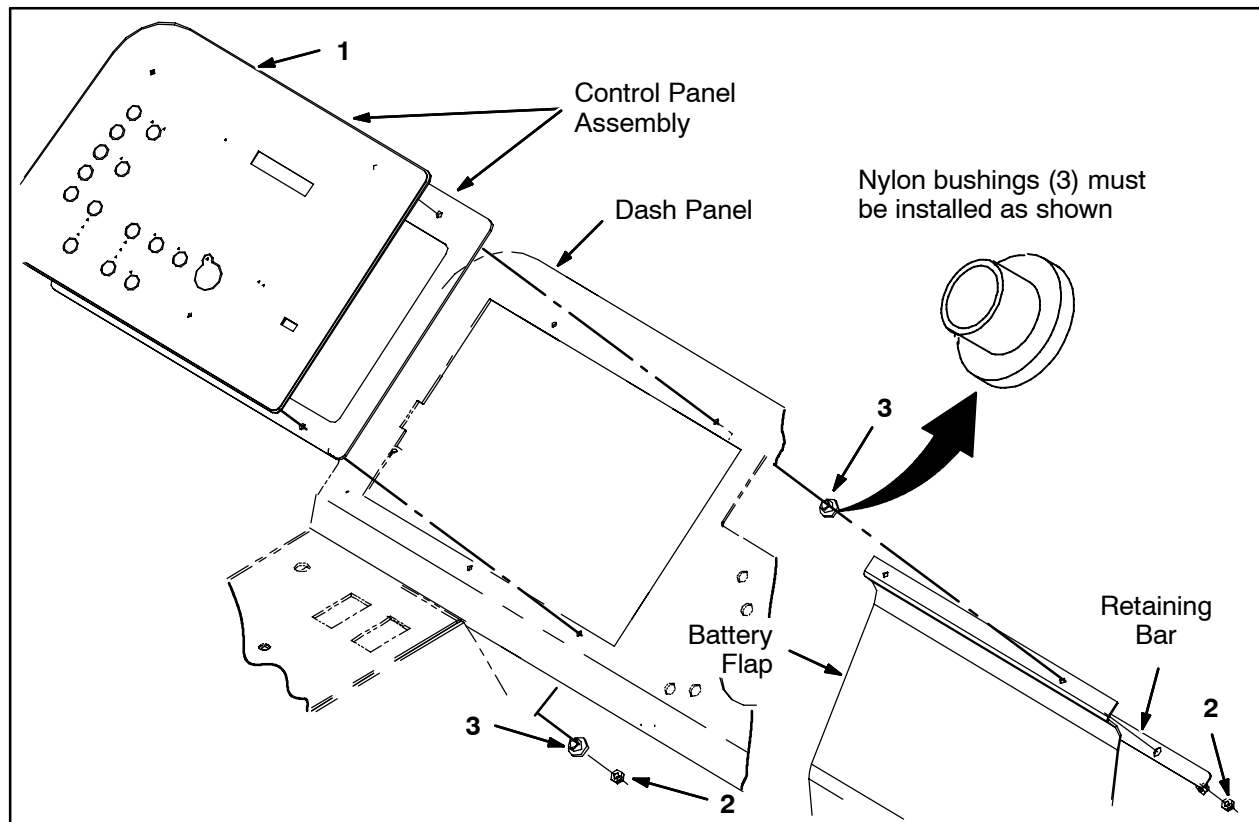

FIG. 3

Bill of Materials for Label Kit, Panel, Replmt [T20]-9002437

	Ref.	Tennant Part No.	Description	Qty.
▽		9002437	Label Kit, Panel, Replmt [T20]	1
▲	1	1027346	Label, Panel. Instmt, Replmt [T20]	1
▲	2	33932	Nut, Hex, Lock, M4 X 0.70, NL, SS	4
▲	3	1029362	Washer, Shld, Nyl [8-32]	4
▲	4	27964	Strap, Ground, Static, Disposable	1

TENNANT COMPANY
P. O. Box 1452
Minneapolis, MN 55440-1452